

BCT 203 Finish Carpentry

INTERIOR DOOR INSTALLATION

WINDOW SURROUNDS

CASING TRIM MOULDING

Door hanging Tools & Materials

- Finish nailer / 2 ½" 15/16 gage / compressor & hose
- 3 - 6 foot level
- Nail set
- Rubber mallet
- vise grips
- finish hammer
- 8 & 10 d casing nails
- 3" gold drywall screws
- Cordless drill w/Phillips
- Phillips screwdriver
- Wonder bar (Pry bar)
- Pre-hung doors
- shims

INSTALLATION PROCEDURE

- Check jamb for plumb. If the RO is not plumb you may be able to toe nail the trimmer to re-align (don't get carried away!) The correction may need to be done using shims between the trimmer and jamb.
- Inspect door for defects or problems difficult to correct once it is hung.
- Remove nail or fastener holding door in jamb. Check jamb width to make sure it will align with opening (finish surface to finish surface). Make sure swing is correct.
- Check that lockset bore is correct.

Continued

- Check floor for level.
- Place door and jamb in rough opening. Shim door jamb bottom up off of low side of opening typically $\frac{1}{2}$ ". Raise opposite jamb until head jamb is level then tack.
- Plumb hinge side jamb in both directions and check that the jamb edge is flush with drywall surfaces on both sides of doorway.
- Place shims at top middle and bottom of the jamb between trimmer and jamb to maintain level and straight.
- Temporally nail hinge side jamb through door stop material. Place nails just below shims.
- **Do not set nails. Do not shim or nail jamb head to header.**

Continued

- Align opposite side of jamb to drywall and tack. Use reveal $\frac{1}{8}$ " shy between door and jamb for alignment. Shim side jamb as necessary and temporarily nail.
- Close door and check the following:
 - Do reveals look uniform?
 - Does the door close flat on the stop?
 - If you answered no, the door needs more adjustment.
 - This may only require adjustment of shims to correct uneven reveal.
 - If the door is not closing flat on the stop the jamb placement will need to be moved. This is why the jamb is only tacked up to this point.

Door Hanging Problems

- Does the door remain stationary in the open position?
- If not check for the following:
 - Is the hinge side of the jamb is out of plumb?
 - Is the jamb edge flush with the wall surfaces?
- If not check for the following:
 - Is the wall plumb?
 - Is the drywall fastened tight to the trimmer?
 - Is the trimmer bowed?
 - Is the jamb stock the proper width?

Door Hanging Complete

- When the door adjustments are complete, you may finish nailing and set the nail heads.
- As a final measure to help prevent future door sag, remove one hinge screw the top hinge (jamb side) and replace with a 3" gold drywall screw that anchors into the trimmer. This will firmly attach the door jamb to framing.

Door Install / Window Surround + Casing

- Select a window surround to assemble.
- After you have completed a window surround, select a door opening to prep.
- Need 4 / 24 doors .
- Work in groups to install on the doors.
- Two students per window to install surround and casing.

Tools & Material

- (2) miter saws
- Casing
- Window surround material
- Doors
- Shims, Glue bottles, Sand paper, casing nails
- Levels(4) finish / (4) brad nailers & 1 1/4" nails & brads (2) narrow crown staplers & 1 1/4" staples (4) air hoses
- Framing squares (in garage)
- Set up (2) saws / Compressor / (2) air hoses per house, (4) nailers, (1) stapler per house.

Project Goals

- Work toward quality finish carpentry workmanship!
- Window / Door casing, No miter gaps and even 3/16" reveals
- Doors close to stops flush with even gaps,

Installing Interior Doors

Prep door opening
remove drywall that protrudes into opening. Check R/O dimensions

Remove door from jamb **Optional**

Tack hinge side plumb
leaving 1/4" adjustment space

Flush jamb edges to drywall
if wall is plumb

If wall is out of plumb split
the difference

Hang the door in the frame
shim so the door has an
equal space clearance
top and opposite side

usually 1/16" to 3/32"

Nail securely and replace the
top hinge center screw with a
3" screw into trimmer

set jamb on a block

1/2" block

Note if the painter is removing the
hinges to paint fudge your clearance
space + 1/32"

after painting install
door hardware

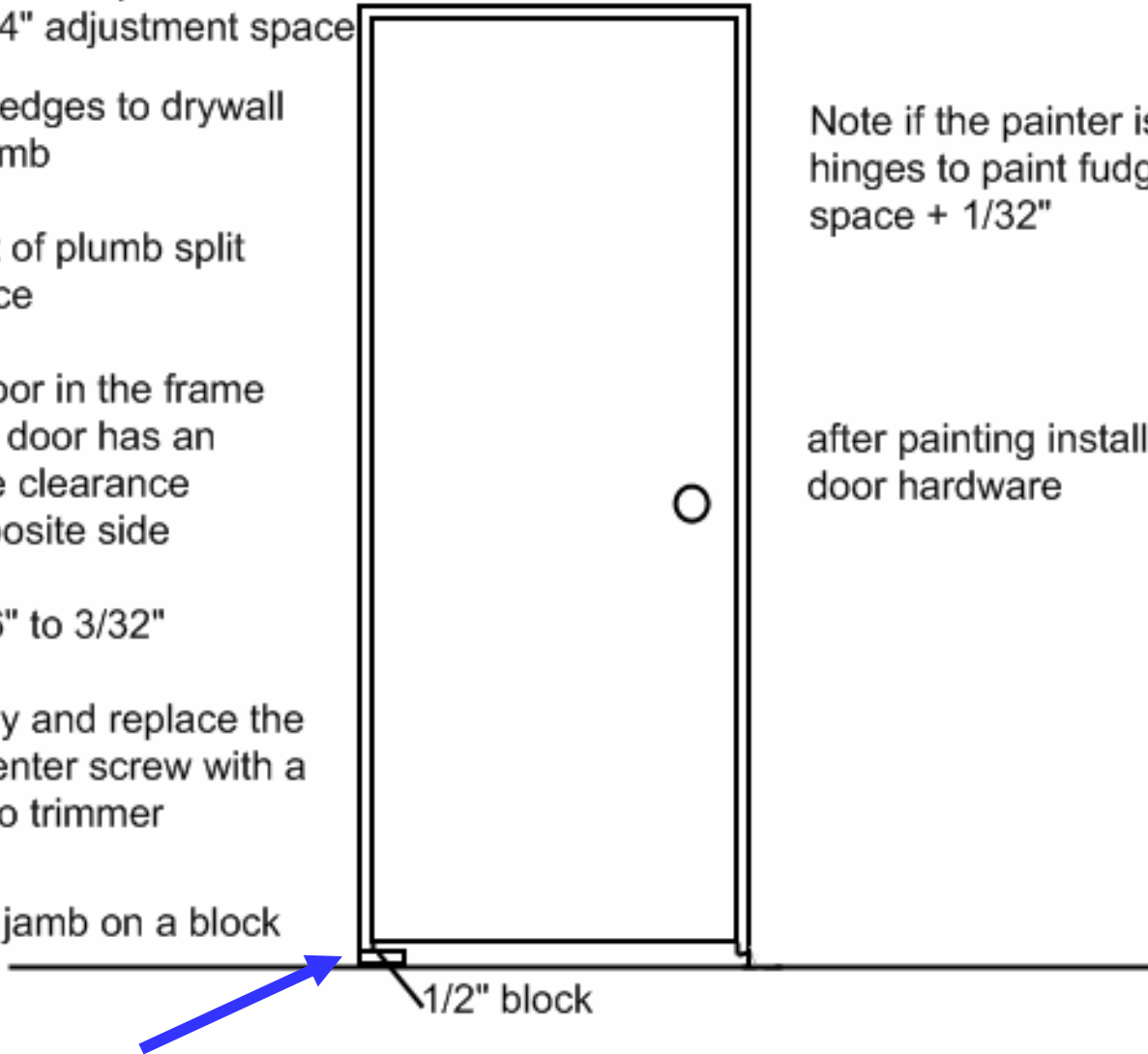



Level

Tack hinge side plumb
in both directions

Shim Straight



Shim opposite side
plumb & straight

Score and break shims
after door is adjusted and
nailed secure.



Door Jamb Adjustment Shims

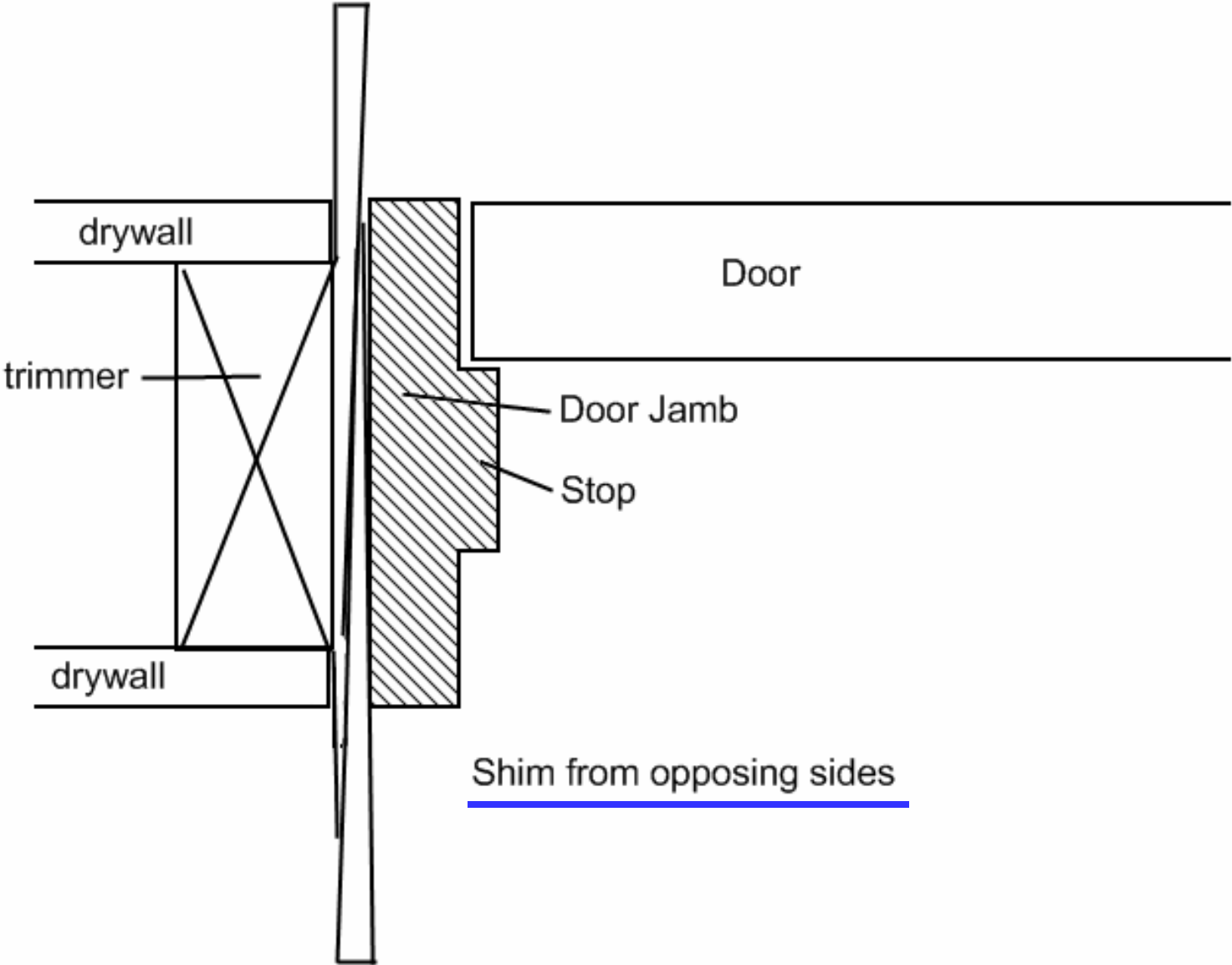

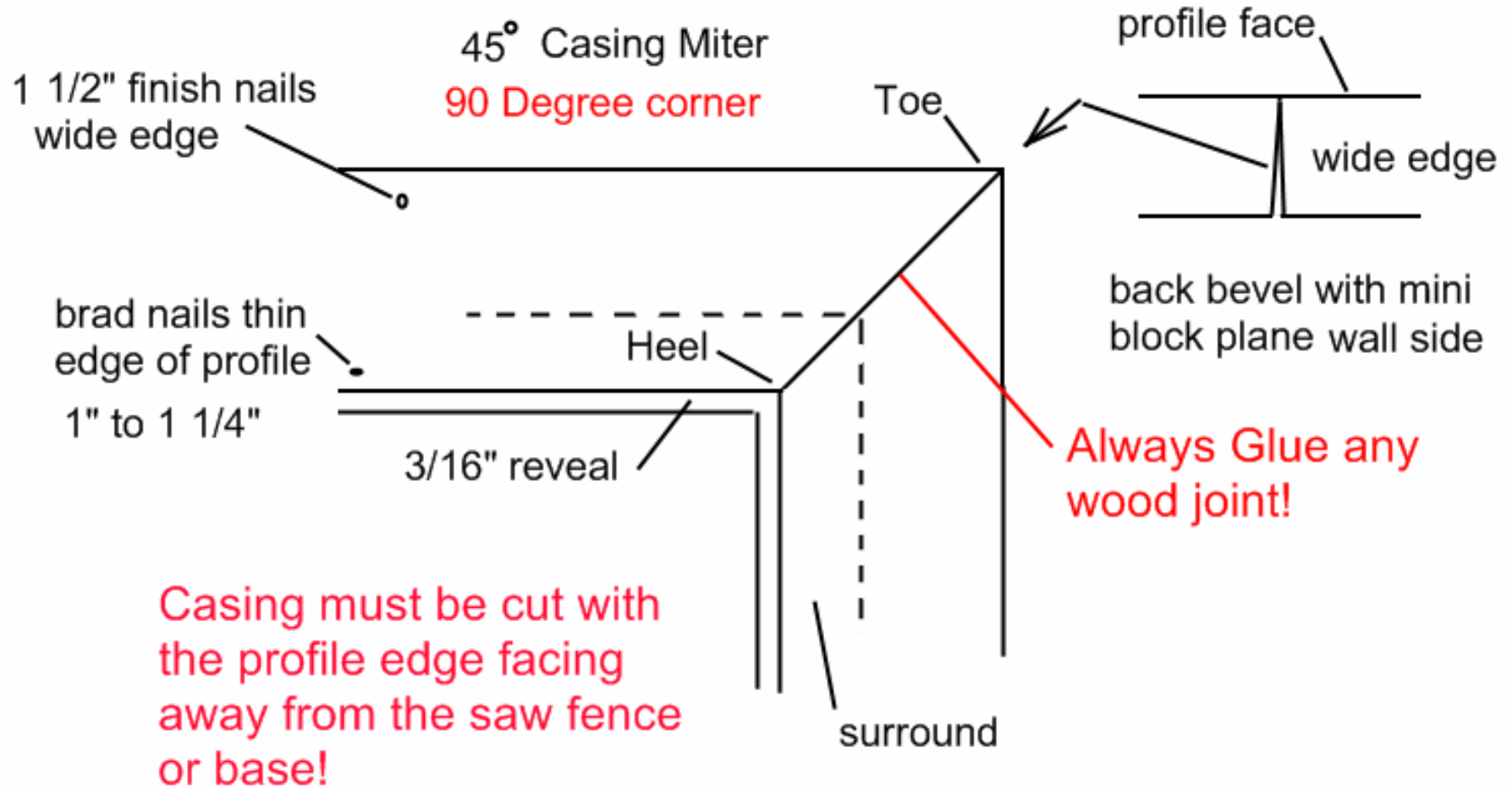

Casing must rest @ 90° of jamb side for
Miter joints to close

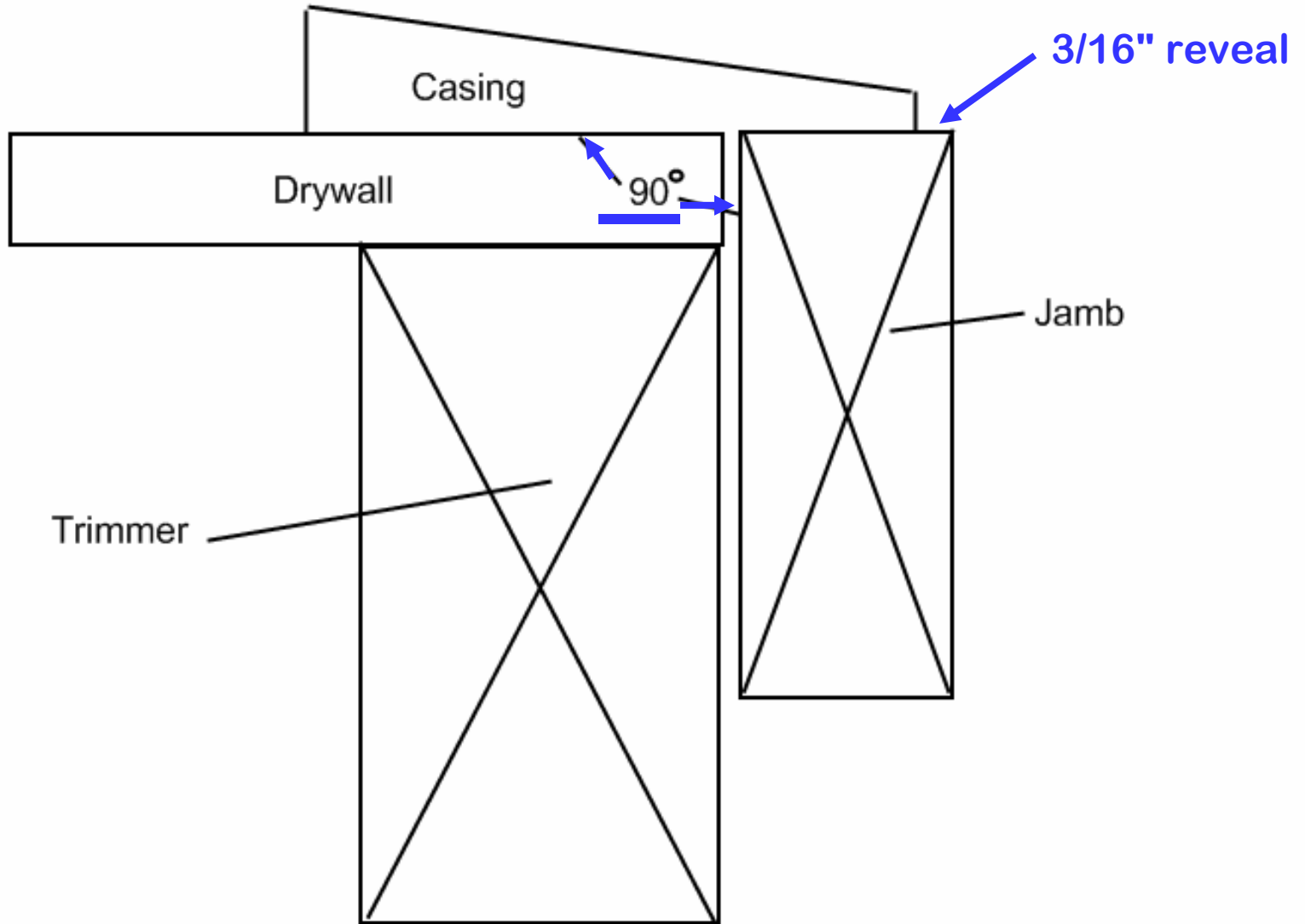

Where drywall extends past jamb edge

Where jamb extends past drywall

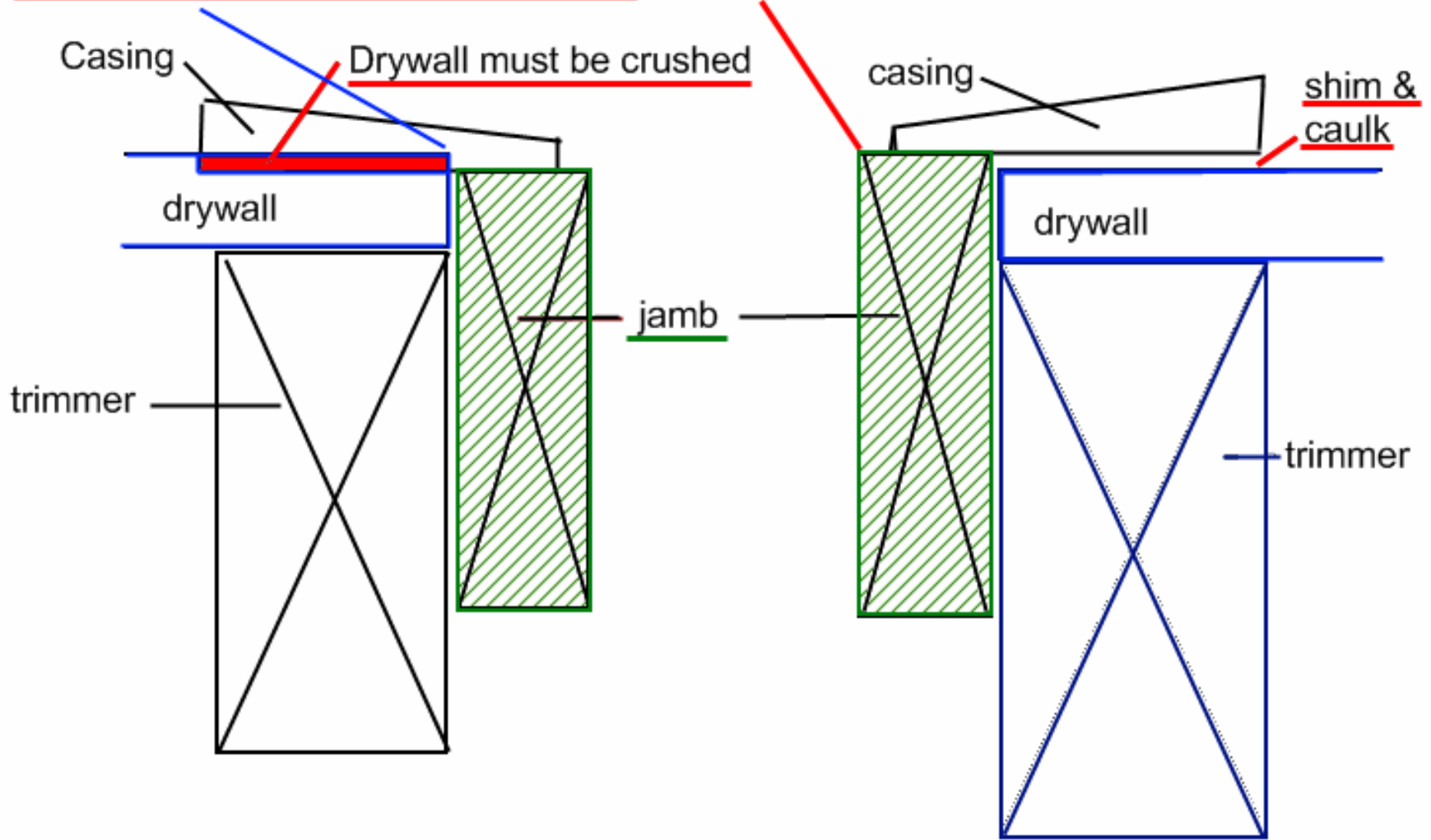

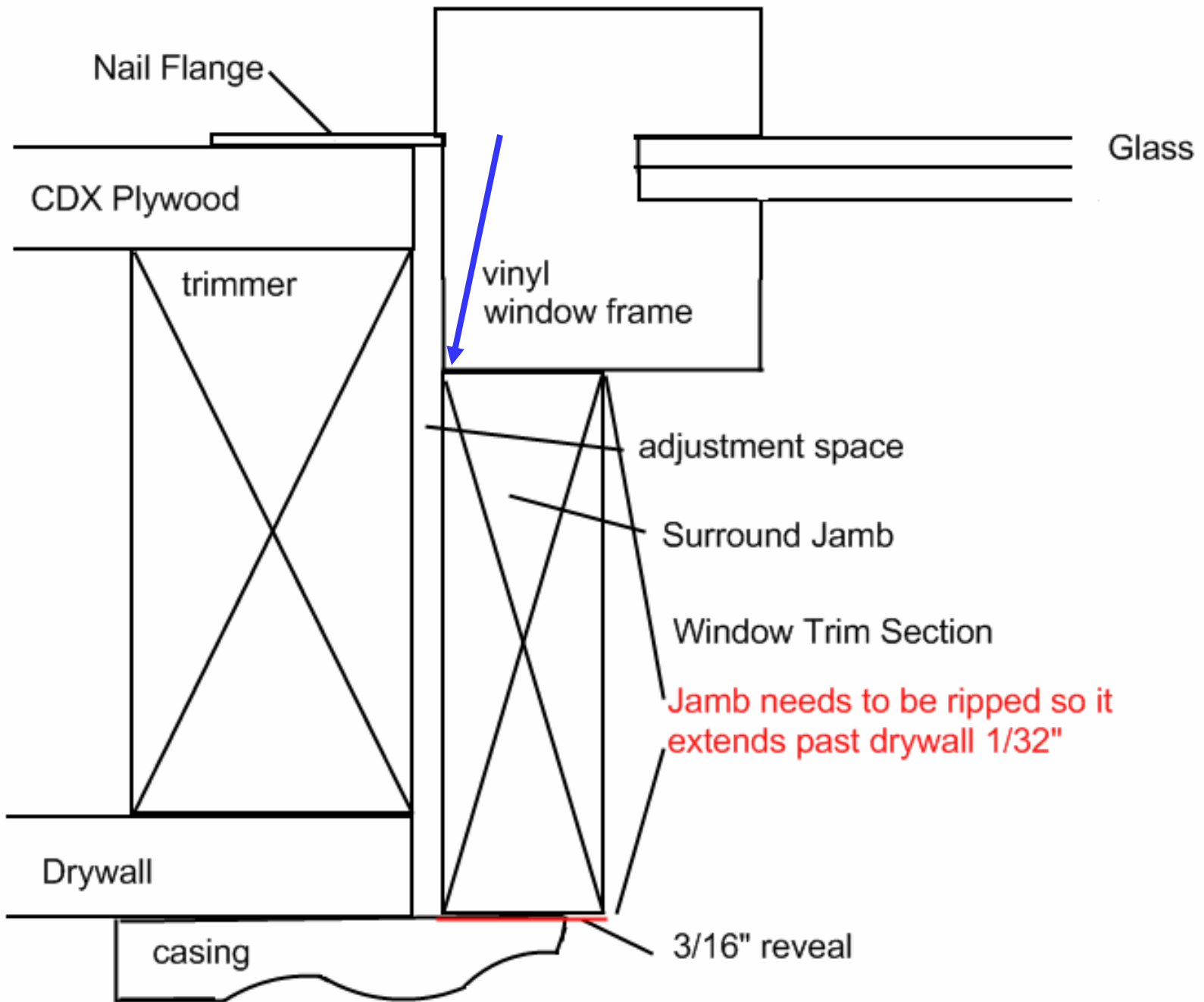

Reveal marking block

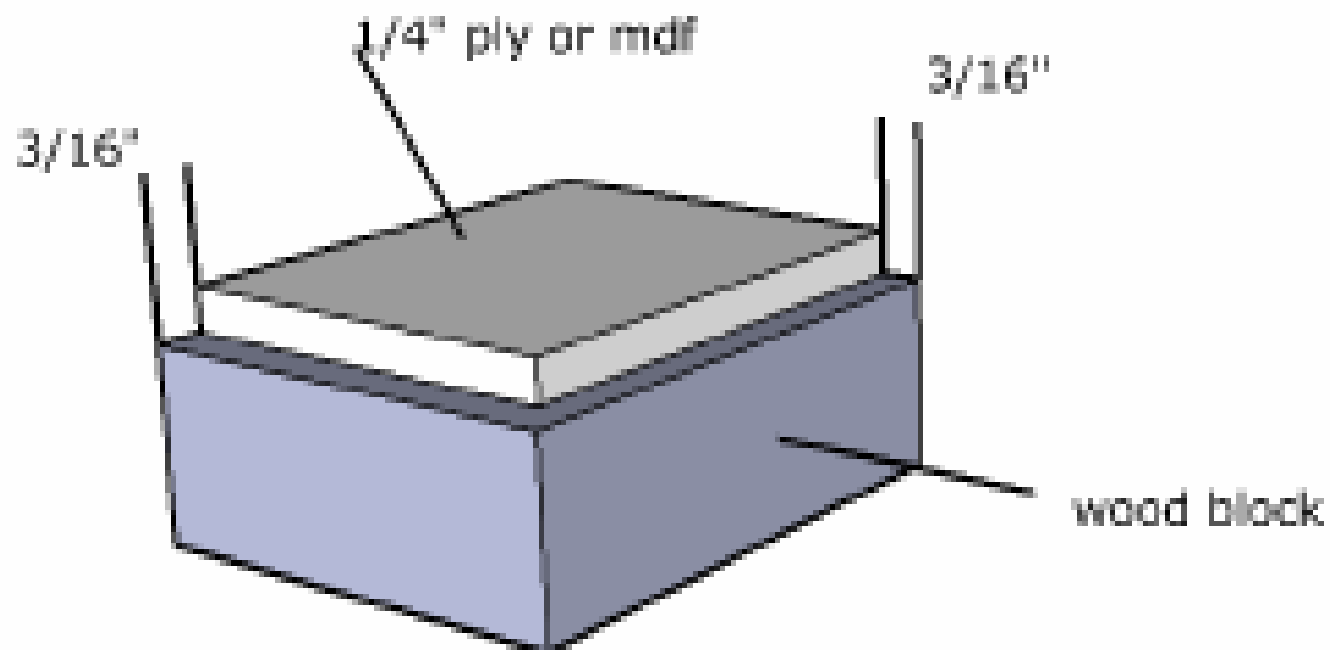

Marking reveal with a tri square

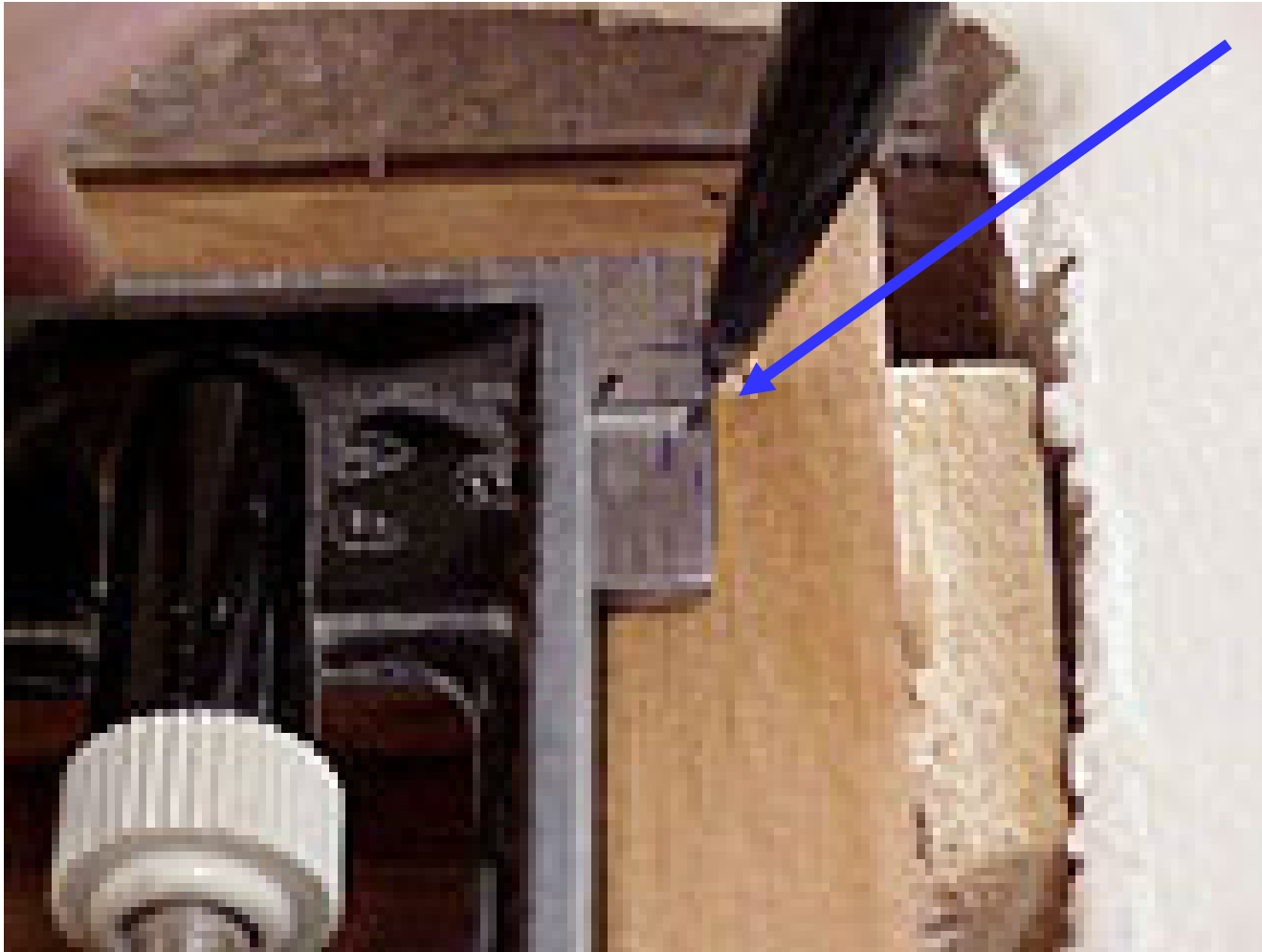

Mark short point (heel) of the casing miter

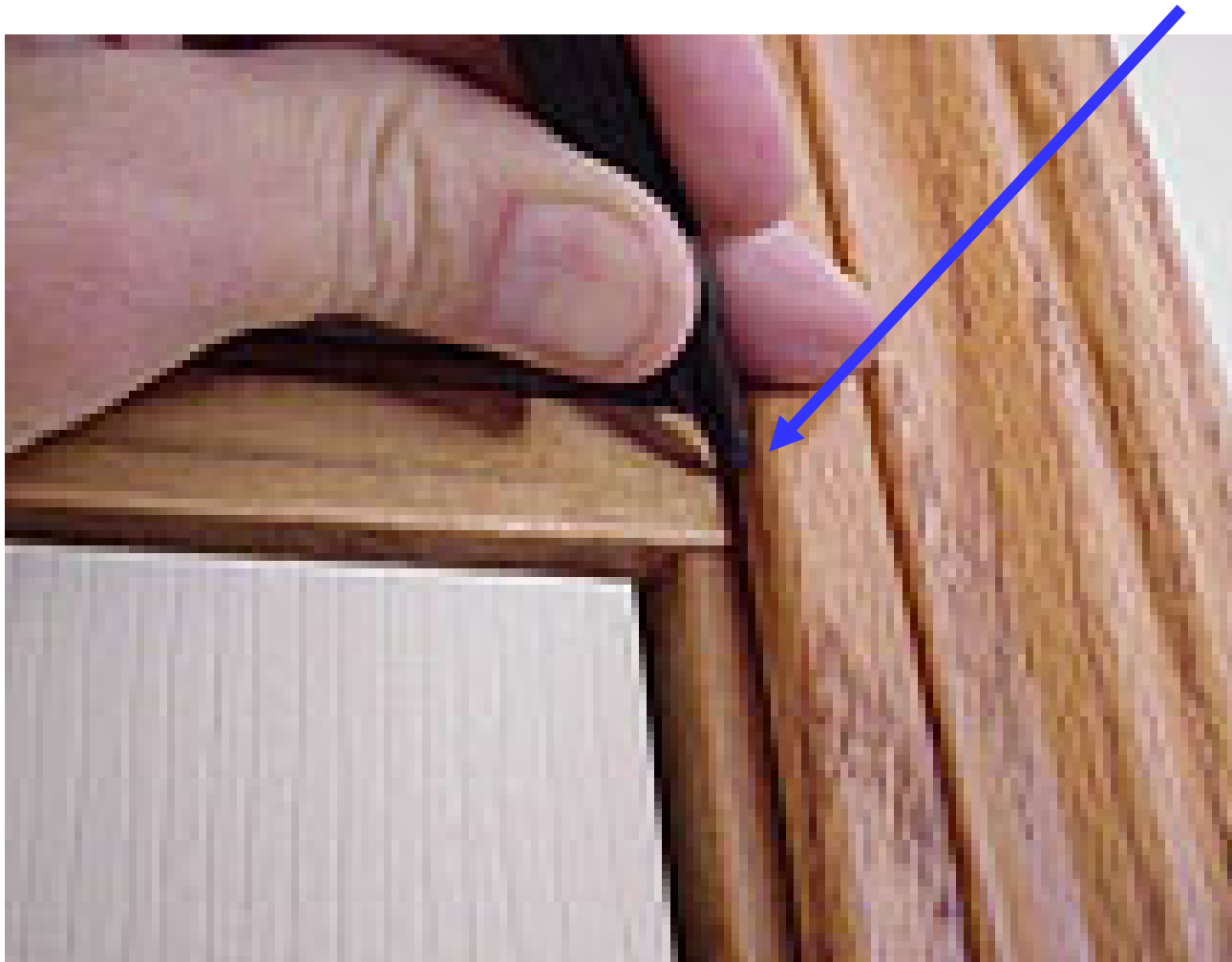

90 degree Windows
Outside edge flush to window frame

1 1/4" narrow
crown staples

Glue

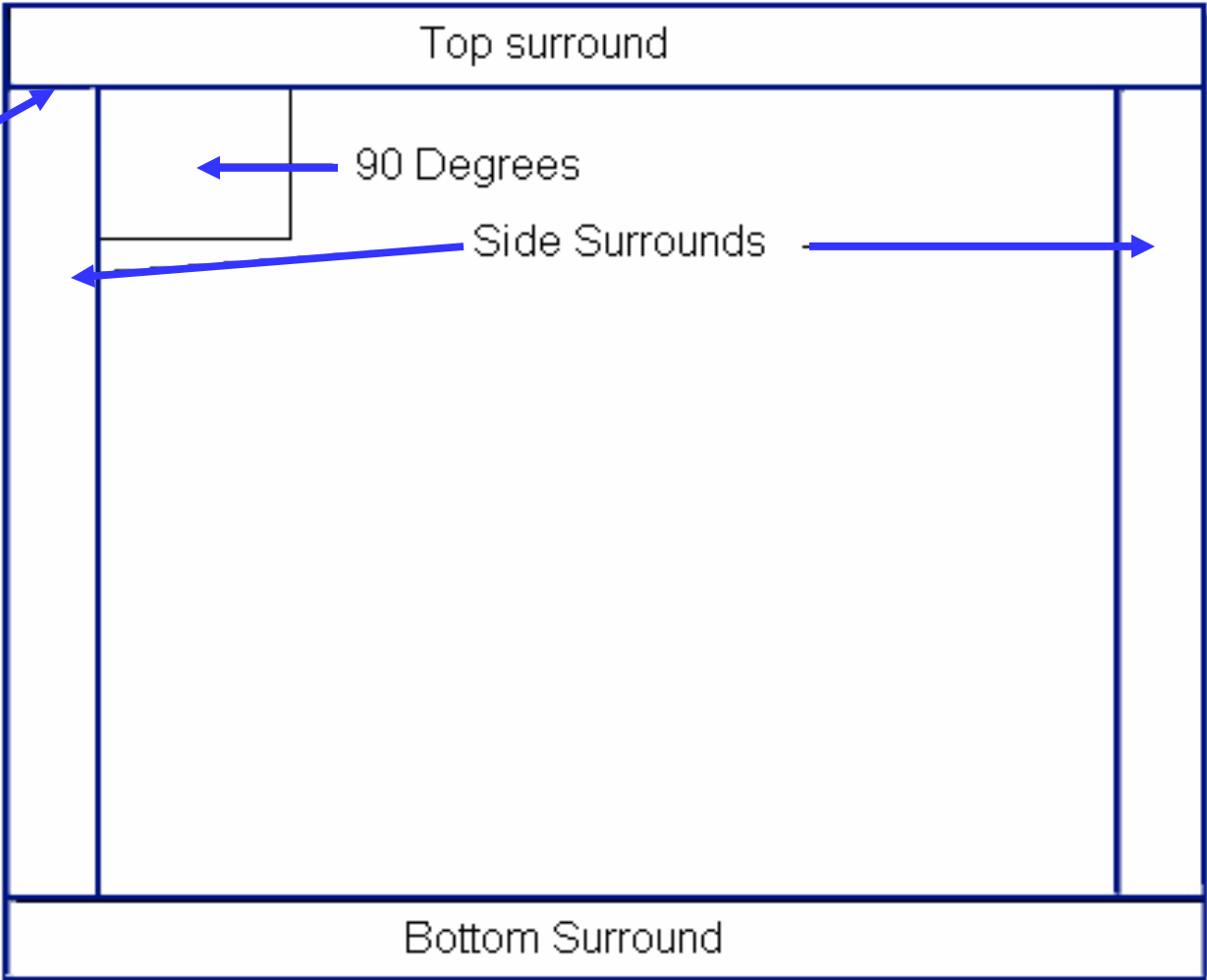

90 Degrees

Side Surrounds

Bottom Surround

